

GKB OPHTHALMICS LTD ISO 9001:2008 CERTIFIED	TECHNICAL DATA SHEET (PLASTIC)	Doc. No.	GKB/O/P/CR-SFKT/13
		Issue No.	05
		Issue Date.	31-07-2015
SEMI-FINISHED CR-39 LENSES			
RI 1.498	LENTICULAR KRYPTOK		67 MM

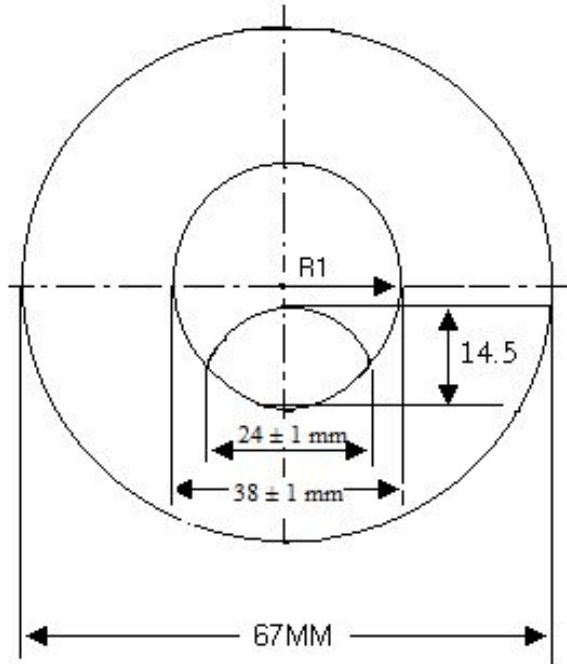

POWER RANGE

Tooling index=1.498

BASE (dpt)	True curve (dpt)	RADIUS OF CURVATURE OF BULGE (mm)	RCC (dpt)	E.T. (mm)
12.00	12.19	40.85	-4.25	9.00
14.00	13.57	36.70	-4.25	9.00
16.00	15.48	32.18	-4.25	9.00
18.00	17.38	28.66	-4.25	9.00
18.00 (Thick)	17.38	28.66	-4.25	12.00

POWER RANGE

BASE (dpt)	ADDITION (dpt)				
	1.50	2.00	2.50	3.00	3.50
12.00	*	*	*	*	*
14.00	*	*	*	*	*
16.00	*	*	*	*	*
18.00	*	*	*	*	*
18.00 (Thick)	*	*	*	*	*

Bevel radius for all base curves: 175.95 mm

ET – EDGE THICKNESS

Prepared by	Approved by	Page 1 of 1
SURAJ AROLKAR	YESHWANT LAWANDE	

GKB OPHTHALMICS LTD ISO 9001:2008 CERTIFIED	TECHNICAL DATA SHEET (PLASTIC)	Doc. No.	GKB/O/P/CR-SFKT/13
		Issue No.	05
		Issue Date.	31-07-2015
SEMI-FINISHED CR-39 LENSES			
RI 1.498	LENTICULAR KRYPTOK		67 MM

AMENDMENT RECORD				
Sr. No.	Old Issue No.	Details of Amendment	Reasons for making the change	New Issue No. with Effective Date
01	04	Added bevel radius and tolerances for bevel	As per customer requirement	Rev 05 Effective from 31 st July 2015

Prepared by	Approved by	Page 2 of 1
SURAJ AROLKAR	YESHWANT LAWANDE	